



Phone 951.738.8380
Fax 951.738.0873

**PACIFIC
CUSTOMS**

visit us at PacificCustoms.com

**This Side Goes
Towards The Rack & Pinion**

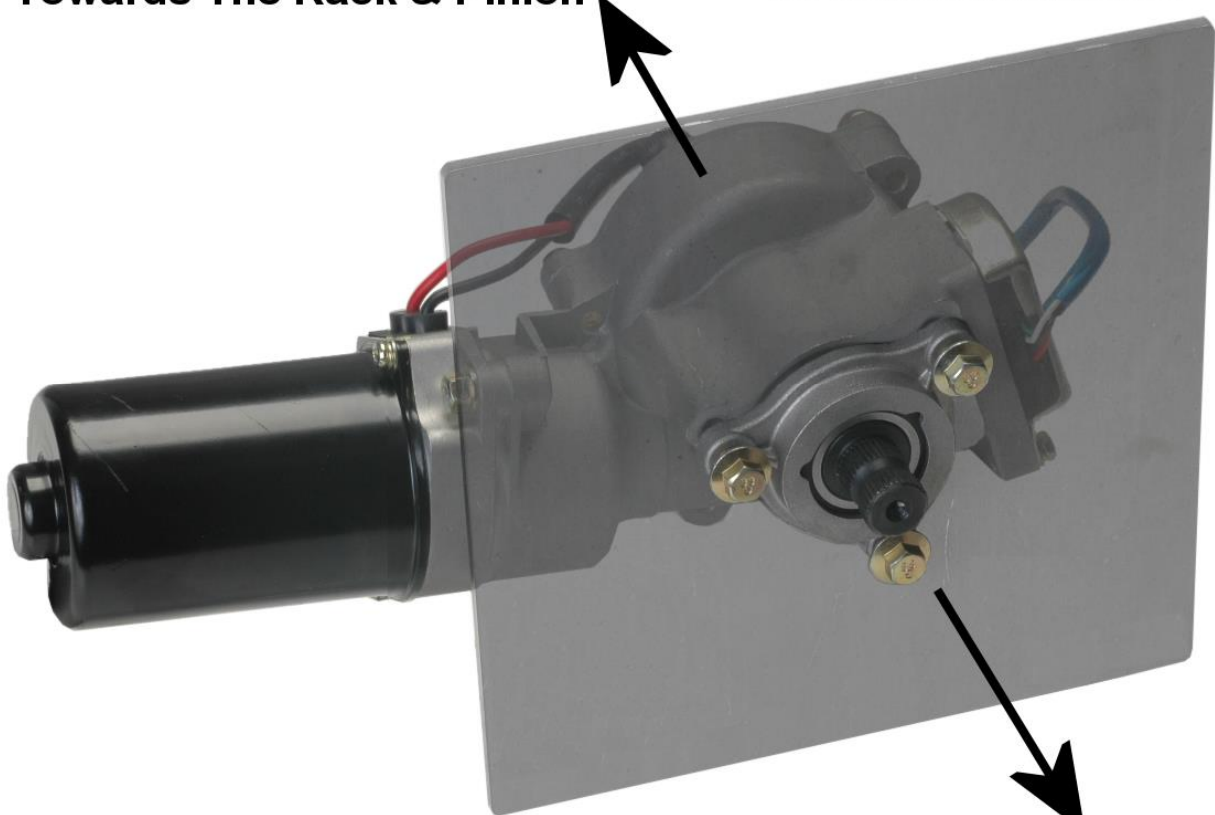

**This Side Goes
Towards The Driver**

White = Ignition On Position
Blue = Ignore OEM Speed Sensor
Black = Idiot Light

To EPS Motor

Red = Battery (+)
Black = Battery (-)

To EPS Motor

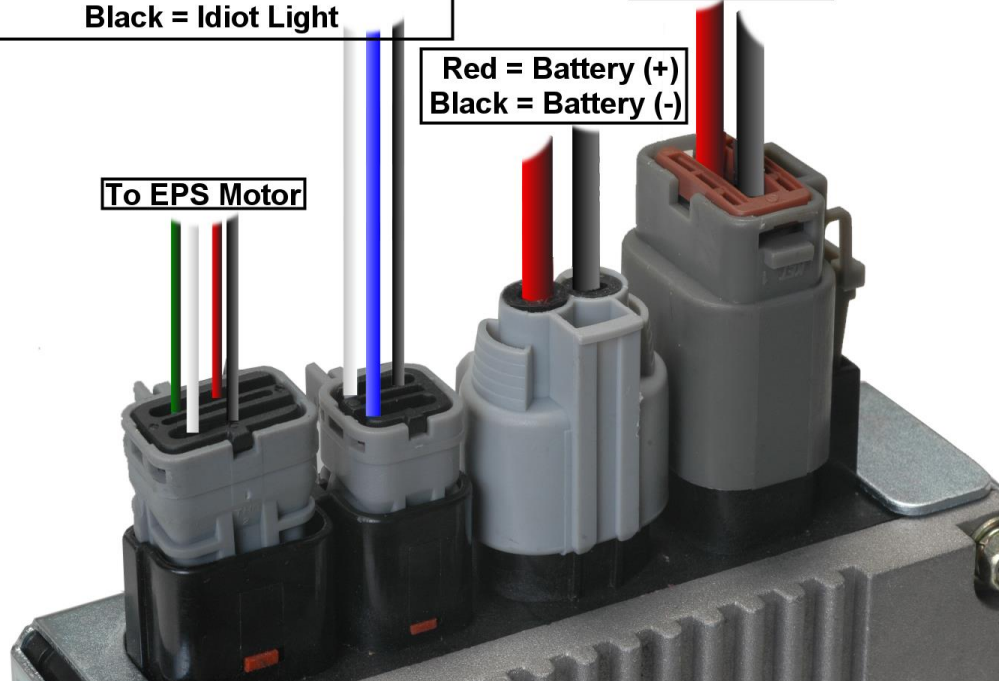

Fault codes show with lamp. Every fault code composed by double digits respectively indicated by long bright lights and the short light number times. Long bright number represents ten digits and short light number represents low single digits. Long bright is 2 seconds and short light 1 second. Lamp dies out 3 seconds between two Fault codes. ****Always check all wiring and connections before replacing components.****

Code	Lamp ON OFF	Fault content	Fault Code Wave	Repair Procedure
10	ECU normal			*Good ECU* Check other Sources of failure
12	ECU inner fault			1. Check all Wiring 2. Replace ECU
21	Main (TS) Torque Sensor disconnection			1. Check Torque sensor/Wiring 2. Replace ECU
22	Main (TS) Torque single output error (high or low voltage)			1. Check Torque sensor/Wiring 2. Replace ECU
23	Sub. (TS) Torque Sensor disconnection			1. Check Torque sensor/Wiring 2. Replace ECU
24	Sub. (TS) Torque single output error (high or low voltage)			1. Check Torque sensor/Wiring 2. Replace ECU
25	Main (TS) Torque and Sub. Torque single differences too big			1. Check Torque sensor/Wiring 2. Replace ECU
26	Main (TS) Torque Sensor inner fault			1. Check Wiring 2. Replace ECU
32	No power assist steering (Left and Right)			1. Check Motor line/Wiring 2. Replace ECU
33	ECU over current			1. Check Wiring 2. Replace ECU
34	No power assist steering (Left or Right)			1. Check Wiring 2. Replace ECU
35	(TS) Torque Sensor current zero off-set			1. Check Motor/Wiring 2. Replace ECU 3. Adjust TS
36	Motor voltage abnormal			1. Check Motor/Wiring 2. Replace Motor 3. Replace ECU